

INON

Grip Base D-PRO

Package contents:

- D-PRO Base ×1 ①
 - Quick Shoe Main Base ×1
 - Quick Shoe W27 Clamp ×2
 - M6x10 Cap Screw ×4
- D-PRO Holder (Right) ×1 ②
 - D5 Holder ×1
 - D5 Lanyard Plate ×1
 - Quick Shoe W27 Clamp ×1
 - Quick Shoe W27 Plate ×2
 - Direct Base III ×1
 - M6x10 Cap Screw ×2
 - M6x18 Low Head Cap Screw ×2
 - M6φ10 Washer ×2
- D-PRO Holder (Left) ×1 ③
 - D5 Holder ×1
 - D5 Lanyard Plate ×1
 - Quick Shoe W27 Clamp ×1
 - Quick Shoe W27 Plate ×2
 - Direct Base III ×1
 - M6x10 Cap Screw ×2
 - M6x18 Low Head Cap Screw ×2
 - M6φ10 Washer ×2
- Quick Shoe L-Type Bracket ×1 ④
- Allen Wrench 2mm ×1
- Allen Wrench 4mm ×1
- Allen Wrench 5mm ×1
- Allen Wrench 3/16 in ×1
- M6x8 Cap Screw ×4
- Rubber Spacer ×2
- Spare O-ring ×2
- This user manual
- User manual Quick Shoe Main Base
- User manual Quick Shoe W27 Clamp
- User manual Quick Shoe W27 Plate
- User manual Quick Shoe L-Type Bracket
- User manual D5 Holder

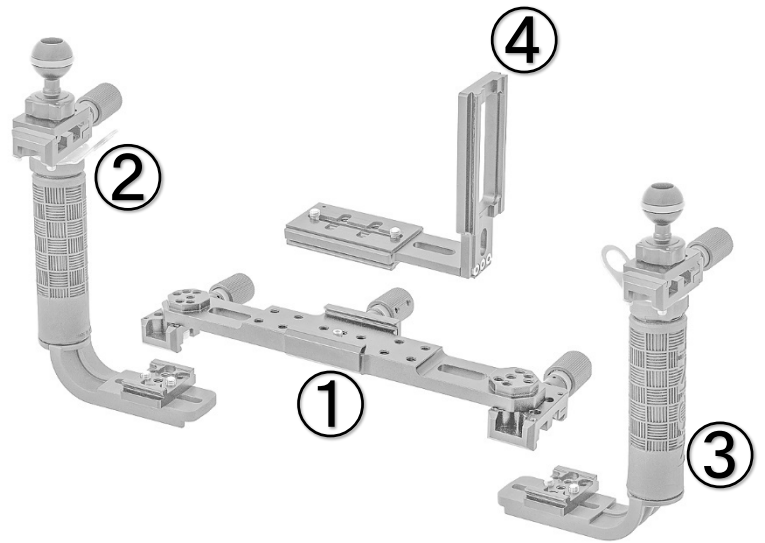

Overview: This product is a packaged product consisting of the following "Quick Shoe Series" etc.

- Quick Shoe Main Base ×1
- Quick Shoe W27 Plate ×4
- D5 Holder ×2
- Direct Base III ×2
- Quick Shoe W27 Clamp ×4
- Quick Shoe L-Type Bracket ×1
- D5 Lanyard Plate ×2

For details, please refer to the user manual of the respective product.

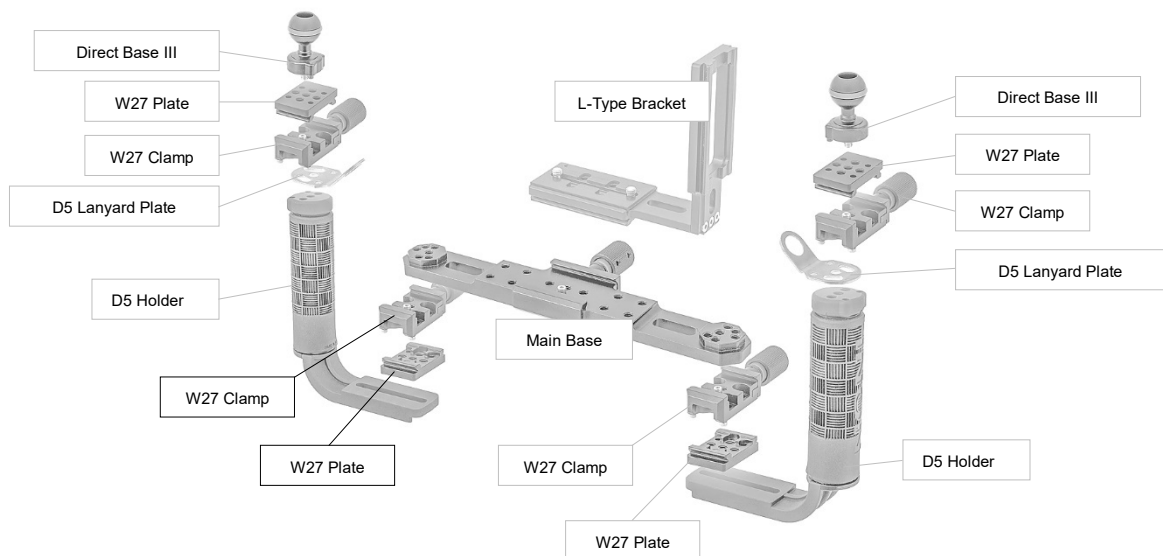

INON

Quick Shoe Main Base

Package contents:

- Quick Shoe Main Base ① ×1
- Allen Wrench 2 mm ② ×1
- This user manual ×1

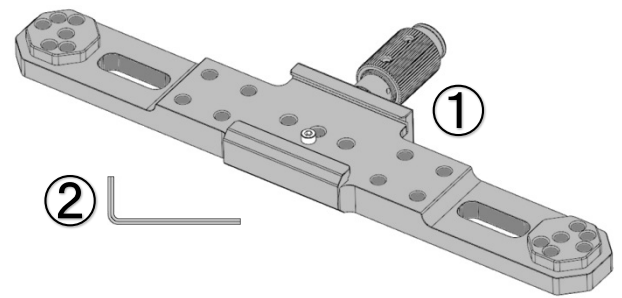

Overview:

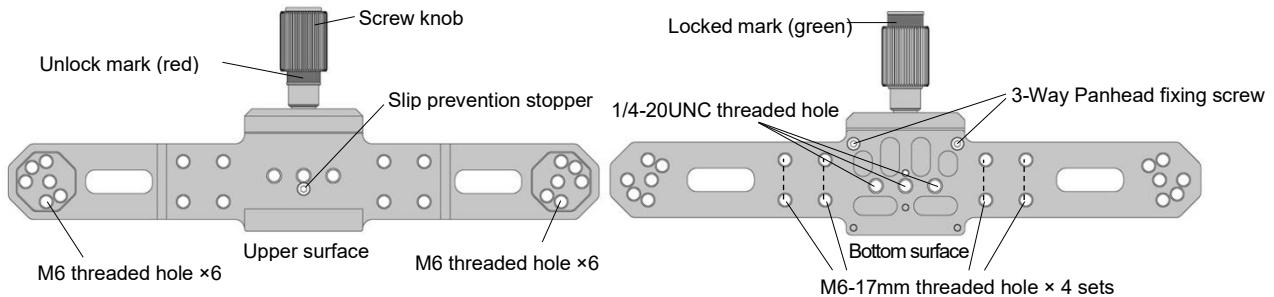

Compatible products

[Quick Shoe]:

- Quick Shoe W50 Plate, Quick Shoe W27 Plate, Quick Shoe W95 Plate
- Quick Shoe L-Type Bracket

Note: Other brands' Arca-Swiss plate is **not** compatible with this product

[Arm Base (bottom surface)] :

- UW 3-Way Panhead, Quick Shoe W50 Plate, Quick Shoe W95 Plate

[Arm System]:

- D5 Holder, Quick Shoe W27 Clamp, Multi Direct Base IIa,
- Multi Direct Base II Long, Multi Direct Base II WB

Installation:

Quick Shoe Plate:

- Unlock the clamp of **Quick Shoe Main Base** by slowly turning the **screw knob** counterclockwise until **red unlock mark** is exposed. Turning the **screw knob** clockwise locks the clamp where **green lock mark** is exposed.

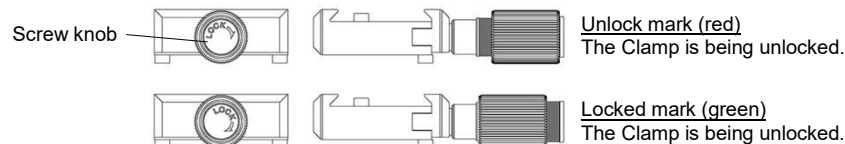

- Securely attach combined **Quick Shoe Plate** on the clamp of the **Quick Shoe Main Base** by engaging their dovetails one by one as per below illustration. Once dovetails have been securely engaged, keep turning the **screw knob** clockwise until **locked mark (green)** is displayed.

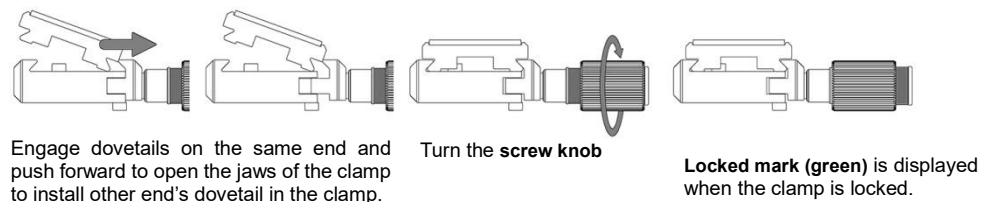

- Make sure to completely tighten the **screw knob** to securely lock the clamp to prevent the **Quick Shoe Plate** from accidentally sliding out of the clamp resulting in damage of combined product or personal injury.

UW 3-Way Panhead:

- Screw the **tripod screw (1/4 in)** of the **UW 3-Way Panhead** into the center **1/4-20UNC threaded hole** on the bottom surface of the **Quick Shoe Main Base**.
- Adjust the **Camera Plate** position so that its convex edge contacts **3-Way Panhead fixing screws** of the clamp part to avoid accidental loose of the **tripod screw (1/4 in)** and rattle.

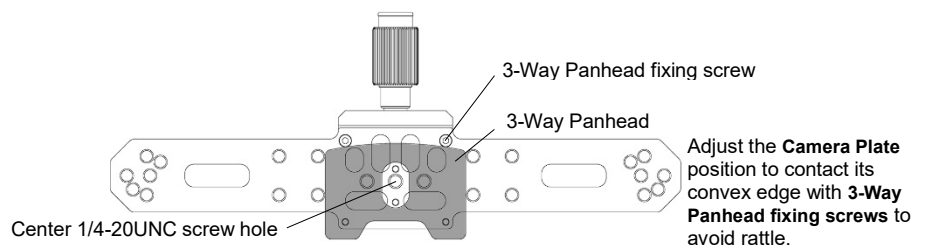

Quick Shoe W50 Plate:
Quick Shoe W95 Plate

- Screw two **1/4-20UNC Cap Screws** of the **Quick Shoe W50 Plate** (or **Quick Shoe W95 Plate**) into the sides **1/4-20UNC threaded holes** on the bottom surface of the **Quick Shoe Main Base** as shown in the right illustration.

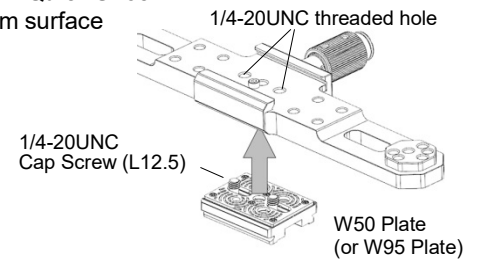

D5 Holder:

- **M6 threaded holes** on the sides can be coupled with the **D5 Holder**.
- The **D5 Holder** can be attached either surface of the **Quick Shoe Main Base (A)(B)**.
- The **D5 Holder** can be attached at an angle of 0, 45 or 90 degree to the **Quick Shoe Main Base (C)**.

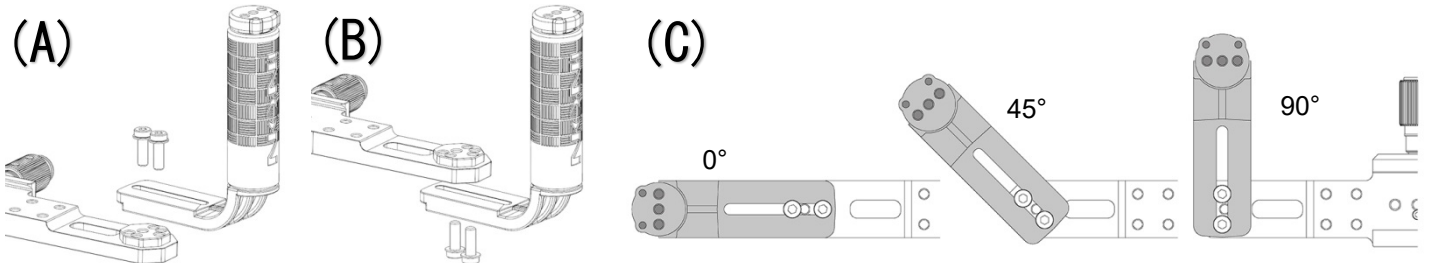

Quick Shoe W27 Clamp:
Multi Direct Base products

- **Quick Shoe W27 Clamp/Multi Direct Base products** can be attached on **M6-17 mm threaded holes** on the bottom surface or **M6 threaded holes** on sides of the **Quick Shoe Main Base**.
- Maximum eight **Quick Shoe W27 Clamps** can be attached on the **Quick Shoe Main Base** (two on the upper surface and six on the bottom surface).
- Maximum four **Multi Direct Base products** can be attached on the bottom surface of the **Quick Shoe Main Base**.

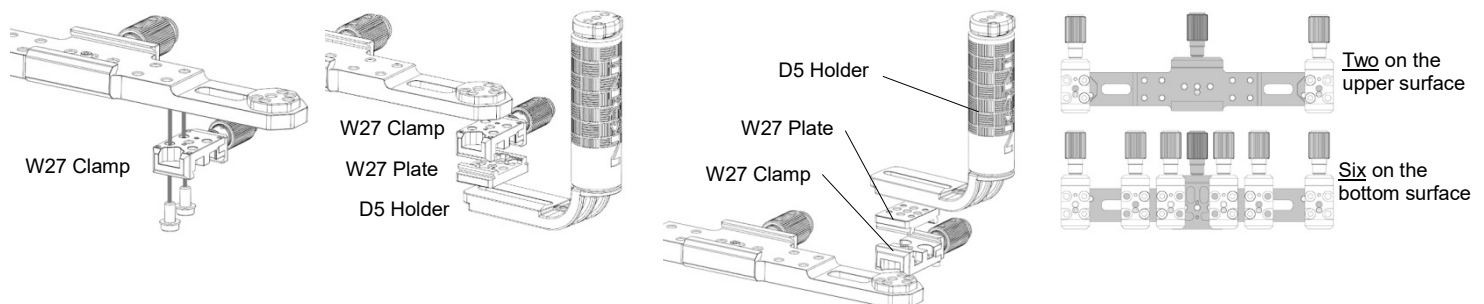

Maintenance:

- After using, soak in fresh water to dissolve remaining salt/remove dirt and dry it in shaded and well ventilated area. Never apply flame or direct heat to this product or damage may result.
- ***DO NOT*** clean with organic solvent like alcohol, benzene or thinner and oil and fat containing/chemical material like rust inhibitor, lubricant, polish, detergent (especially alkaline detergent) to avoid damage/deformation/degradation of this product.
- Periodically apply grease on metal part of screws to prevent them from rusting.

Storage:

- After completely dry, store out of direct sunlight in well-ventilated, dry area. Avoid storing near chemicals, high ozone, large temperature and humidity fluctuations to avoid deformation, damage, rust, mold or corrosion etc.
- Keep the product out of reach of children. They may swallow parts of this product. See a doctor immediately if a child swallow parts.

Handling:

- Make sure to follow installation procedures described in this manual. Insufficient tightening of the **screw knob** may lead to accidental separation/damage/loss of combined products and/or damage.
- ***DO NOT*** use this product for non-compatible products to avoid accidental separation/damage/loss of combined products. Use only with compatible products listed in this user manual.
- Securely hold this product/combined products during transportation of whole system without applying excessive shock, vibration and/or pressure. ***DO NOT*** hold compatible products only to transport whole system to avoid accidental separation/damage/loss of combined housing/products.

INON

Quick Shoe W27 Clamp

Package contents:

- W27 Clamp Body ① ×1
- M6x10 Cap Screw ② ×2
- Allen Wrench 2mm ③ ×1
- Allen Wrench 5mm ④ ×1
- This user manual ×1

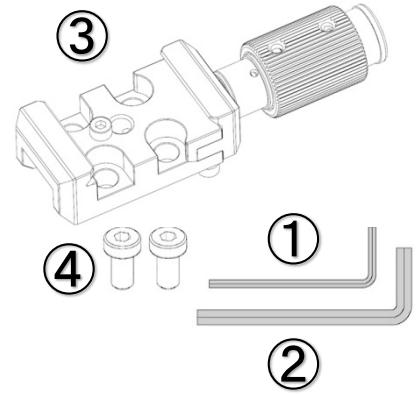

Overview :

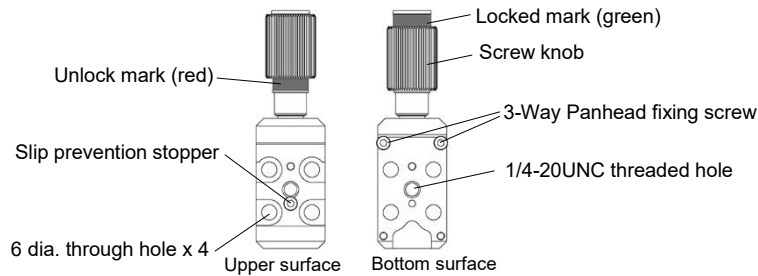

Compatible products

[Quick Shoe]:

- Quick Shoe W50 Plate, Quick Shoe W27 Plate, Quick Shoe W95 Plate
- Quick Shoe L-Type Bracket

Note: Other brands' Arca-Swiss plate is **not** compatible with this product

[Arm Base]:

- Quick Shoe Main Base, UW 3-Way Panhead, UW Tripod Hub, Shoe Base 1/4-20UNC

[Arm System]:

- D5 Holder, Grip Base D4/D Holder, Holder III

Installation

Quick Shoe Plate:

- Slowly turn the screw knob counterclockwise to unlock until **red unlock mark** is exposed. Turning the screw knob clockwise locks the clamp where **green lock mark** is exposed.

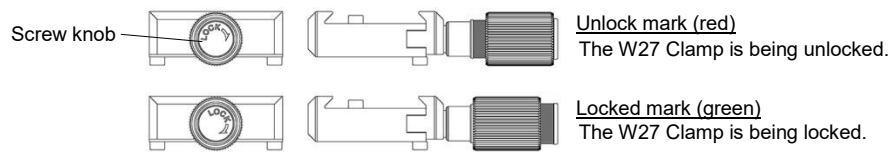

- Securely attach combined **Quick Shoe Plate** on the **W27 Clamp Body** by engaging their dovetails one by one as per below illustration. Once dovetails have been securely engaged, keep turning the **screw knob** clockwise until **locked mark (green)** is displayed.

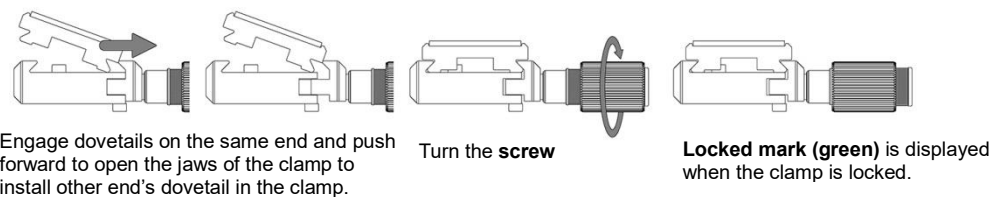

- Make sure to completely tighten the **screw knob** to securely lock the clamp to prevent the **Quick Shoe Plate** from accidentally sliding out of the clamp resulting in damage of combined product or personal injury.

Quick Shoe Main Base:

- Match the **6 dia. through holes** of the **W27 Clamp Body** to **M6 screw holes** of the **Quick Shoe Main Base** then fasten them with supplied two **M6x10 Cap Screws** by tightening them with supplied **Allen Wrench 5 mm**.
- The **Quick Shoe Main Base** can hold maximum eight **Quick Shoe W27 Clamps** (two on the top surface and six on the bottom surface) as show in the illustration below.

Maximum configuration

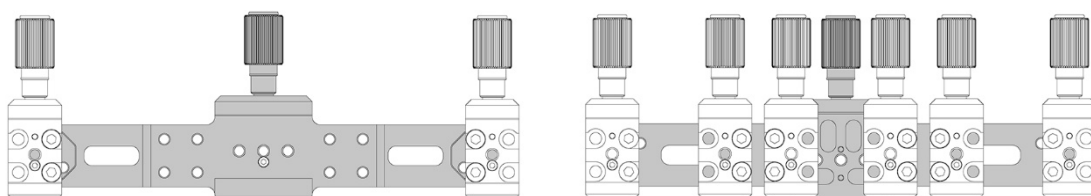

Quick Shoe Main Base top surface

Quick Shoe Main Base bottom surface

Installation**UW 3-Way Panhead:**

- Screw the **Tripod Screw (1/4 in)** of the **UW 3-Way Panhead** into the **1/4-20UNC screw hole** on the bottom surface of the **W27 Clamp Body**.
- Adjust the **Camera Plate** position so that its convex edge contacts **3-Way Panhead fixing screws** of the **W27 Clamp Body** to avoid accidental loose of the **Tripod Screw (1/4 in)** and rattle of the **Quick Shoe W27 Clamp** then tighten the **Tripod Screw (1/4 in)** completely.

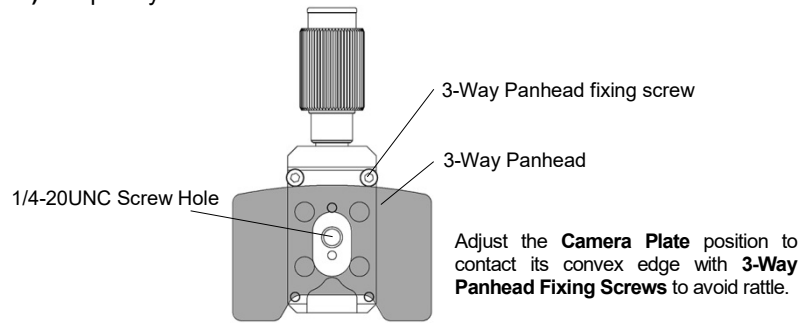
**UW Tripod Hub:****Shoe Base 1/4-20UNC**

- Screw the **Tripod Screw (1/4 in)** of the respective product into the **1/4-20UNC screw hole** on the bottom surface of the **W27 Clamp Body** to fasten two components.

D5 Holder:**D Holder****Holder III**

- Match **M6 screw holes** on the top edge of the respective product to **6 dia. through holes** and fasten with supplied two **M6x10 Cap Screws** by tightening them with supplied **Allen Wrench 5 mm**.

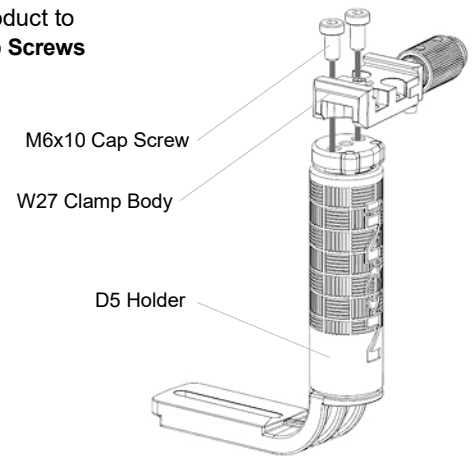
**Maintenance:**

- After using, soak in fresh water to dissolve remaining salt/remove dirt and dry it in shaded and well ventilated area. Never apply flame or direct heat to this product or damage may result.
- **DO NOT** clean with organic solvent like alcohol, benzene or thinner and oil and fat containing/chemical material like rust inhibitor, lubricant, polish, detergent (especially alkaline detergent) to avoid damage/deformation/degradation of this product.
- Periodically apply grease on metal part of screws to prevent them from rusting.

Storage:

- After completely dry, store out of direct sunlight in well-ventilated, dry area. Avoid storing near chemicals, high ozone, large temperature and humidity fluctuations to avoid deformation, damage, rust, mold or corrosion etc.
- Keep the product out of reach of children. They may swallow parts of this product. See a doctor immediately if a child swallow parts.

Handling:

- Make sure to follow installation procedures described in this manual. Insufficient tightening of the **screw knob** may lead to accidental separation/damage/loss of combined products and/or damage.
- **DO NOT** use this product for non-compatible products to avoid accidental separation/damage/loss of combined products. Use only with compatible products listed in this user manual.
- Securely hold this product/combined products during transportation of whole system without applying excessive shock, vibration and/or pressure. **DO NOT** hold compatible products only to transport whole system to avoid accidental separation/damage/loss of combined housing/products.

INON

Quick Shoe W27 Plate

Package contents :

- W27 Plate① ×1
- This user manual ×1

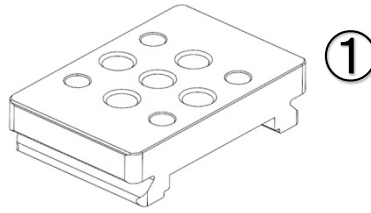

Compatible products:

- Quick Shoe W50 Clamp
- [Quick Shoe]** • Quick Shoe W27 Clamp
- Quick Shoe Main Base

Compatible products:

- Direct Base III
- [Arm System]** • Multi Direct Base IIa, Multi Direct Base II Long
- Multi Direct Base II WB, Z Adapter II
- Direct Base YS RT, Shoe Base Adapter D4
- D5 Holder, Z Joint

Installing Arm System : The **W27 Plate** is equipped with **M6 threaded holes** and **4 dia. through holes** to attach variety of adapters.

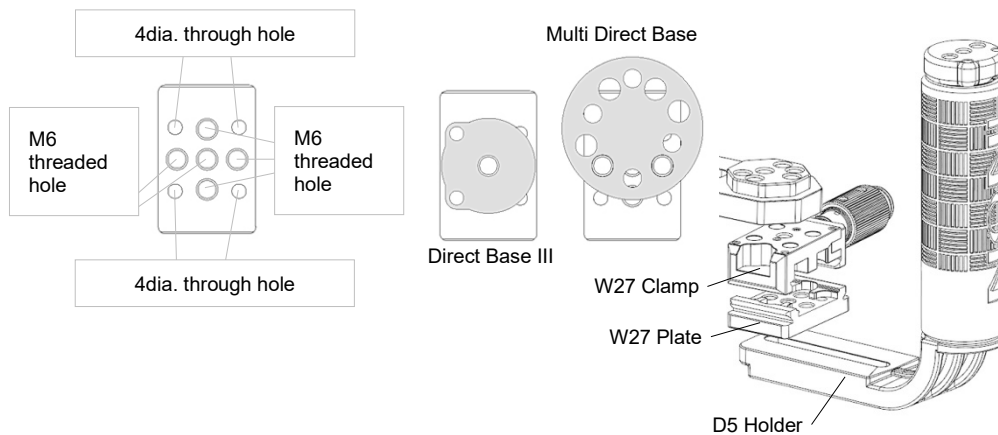

INON INC. 2-18-9, Dai, Kamakura, Kanagawa 247-0061 JAPAN
 E-mail support@inon.co.jp, Fax +81(0)467-48-2178
 URL <http://www.inon.jp/>

As of October 2020

INON

Quick Shoe L-Type Bracket

- Package contents:**
- L-Type Bracket ×1
 - L-Type Bracket Body ① ×1
 - 1/4-20UNC Cap Screw (L12.5) ② ×2
 - M6 Washer ③ ×2
 - Allen Wrench 3/16 in ④ ×1
 - This user manual ×1

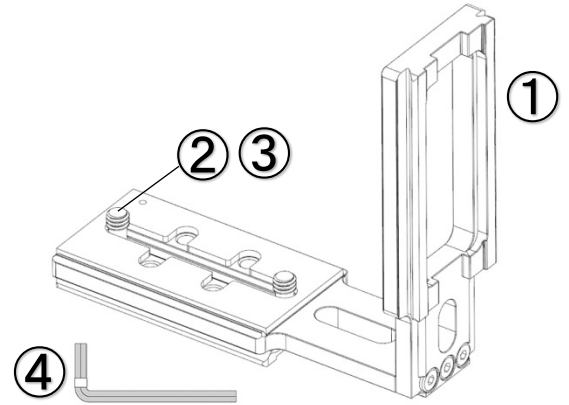

- Compatible products:**
- [Quick Shoe]**
- Quick Shoe W50 Clamp
 - Quick Shoe W27 Clamp
 - Quick Shoe Main Base

- Compatible products:**
- [Housing]**
- INON X-2 series housing
 - Other brands' housings * **

* Two 1/4 inch screw holes with center-to-center distance of 12 – 56 mm/0.5 - 2.2 inch are required and distance between center 1/4 inch screw hole and left end of the housing must be less than 100 mm/3.9 inch including a protruded part of the housing body, to install this product.

DO NOT use the **L-Type Bracket** if it prevents the combined housing from proper opening/closure to avoid accidental damage/flooding of the housing.

** INON INC. has not confirmed compatibility with specific housing from other manufacture. Before using, make sure to check if the housing from other manufacture is compatible with this product and does not interfere with other combined product(s).

- Compatible products:**
- [Arm system]**
- Multi Direct Base IIa, Multi Direct Base II Long
 - Multi Direct Base II WB

- Installation**
- : Place the **L-Type Bracket** on to a combined housing at its tripod screw holes on the bottom so that slotted hole of the **L-Type Bracket** covers the tripod screw holes and partially/evenly tighten pre-installed 1/4-20UNC Cap Screws (L12.5) by supplied Allen Wrench 3/16 inch. Check/adjust the **L-Type Bracket** position and completely tighten the 1/4-20UNC Cap Screws (L12.5).

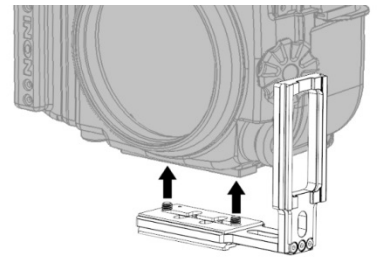

Slotted holes' ends have **1/4-20UNC thread** as per the right illustration to use when removing pre-installed **1/4-20UNC Cap Screw (L12.5)**.

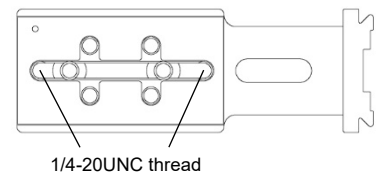

- Installing Arm System**
- : The **L-Type Bracket** is equipped with **M6 threaded holes** to attach variety of adapters.

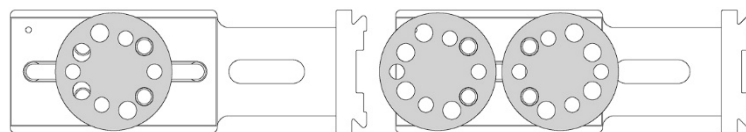

Maximum two **Multi Direct Base** products can be installed.

INON

D5 Holder

Thank you for purchasing INON product.

- Package contents:**
- D5 Holder ①×1
 - M6x18 Low Head Cap Screw ②×2
 - M6φ10 Washer ③×2
 - Allen Wrench (WAF: 4mm) ④×1
 - This user manual ×1

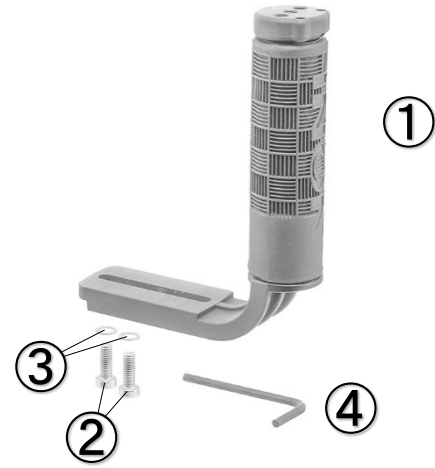

- Compatible products** :
- *D5 Base, Main Base III*

【Base plate】

The *D5 Holder* is **NOT** compatible with *D Base SPS* (Grip Base D4) and *D Base M1*(Grip Base M1).

- *SD Front Mask for HERO5/6/7* (*1)
- *SD Front Mask STD* (*1)
- *SD Mount Cage for HERO3/3+/4* (*1)
- *SD Mount Base for TG-Tracker* (*1)
- *SD Mount Base for UWH1* (*1)

(*1) Attached on bundled *Mount Adapter*

Compatible Products
【Arm system】

- :
- *Direct Base III*
 - *Multi Direct Base IIa, Multi Direct Base II Long*
 - *Multi Direct Base II WB, Z Adapter II*
 - *Direct Base YS RT*
 - *Shoe Base Adapter D4 + Shoe Base 1/4-20UNC/Shoe Base M6*
 - *Shoe Base Adapter D4 + Shoe Base BALL/Shoe Base II*

Installing on a Base Plate

- :
- Attach the *D5 Holder* with supplied two pairs of *M6 Low Head Cap Screw/M6φ10 Washer* to the M6 screw holes on the compatible base plate as per shown in the right image.

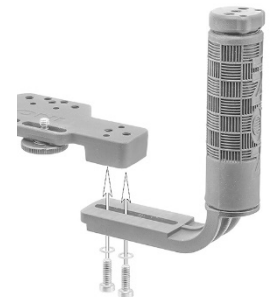

Arm system installation

- :
- The top of the *D5 Holder* can hold compatible arm system.



Maintenance

- :
- After using, soak in fresh water to dissolve remaining salt or remove dirt and dry it in shaded and well ventilated area. Never apply flame or direct heat to this product or damage may result
 - Do not clean with organic solvent like alcohol, benzene or thinner and oil and fat containing / chemical material like rust inhibitor, lubricant, polish, detergent (especially polyoxymethylene) to avoid damage/deformation/degradation of this product.
 - Periodically apply grease (grease for housing) on metal part of screws to prevent rust.

Storage

- :
- Store out of direct sunlight in well-ventilated, dry area. Avoid storing near chemicals, high ozone, large temperature and humidity fluctuations to avoid deformation, damage, rust, mold or corrosion etc.

- Keep the product out of reach of children. They may swallow parts of this product. See a doctor immediately if a child swallow parts.

Handling precautions

- Make sure to follow installation procedures described in this manual. Insufficient tightening of *M6 Low Head Cap Screw* may lead to accidental separation of combined products and/or damage.
- DO NOT use this product for non-compatible products to avoid accidental separation of combined products and/or damage. Use only with compatible products listed in this user manual.
- Hold this product during transportation of whole system without applying excessive shock, vibration and/or pressure. Do not hold compatible products to transport whole system to avoid accidental separation of combined housing/protector causing damage on them.

INON D5 Holder specifications [*1]

Model	D5 Holder
Size	W208.5(8.2") x H142.5(5.6") x D32mm (1.3")
Weight	Air: 158g (5.6oz) / Underwater: approx 70g (2.5oz)
Material / finishing	Corrosion-resistant aluminum alloy/rigid alumite/ POM etc.

*1 Subject to change without prior notice

INON Inc.

2-18-9, Dai, Kamakura,
Kanagawa 247-0061 JAPAN
E-mail support@inon.co.jp
Fax. +81(0)467-48-2178
URL <http://www.inon.jp/>

December 2019