

INON

INON GX Standard Port M67/LD

Thank you for purchasing INON product.

INON *GX Standard Port M67/LD* is a dedicated port to use Panasonic *LUMIX G VARIO 14-42mm/F3.5-5.6 II ASPH./MEGA O.I.S. with INON X-2 for GX9* housing.

Two options are available: *GX Standard Port M67* with versatile M67 screw mount, and *GX Standard Port LD* with INON lockable LD bayonet mount giving speedy and easy lens exchange underwater.

Features

- The lens mount of the port edge is interchangeable depending on wet lens to use either M67 screw mount, or LD lockable bayonet.
- Using multi-coated optical glass serves you sharp and high contrast image without flare/ghost.

Package contents :

- GX Standard Port M67/LD ×1
- INON Grease ×1
- This user manual ×1

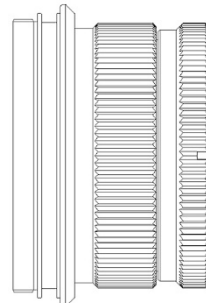

GX Standard Port M67

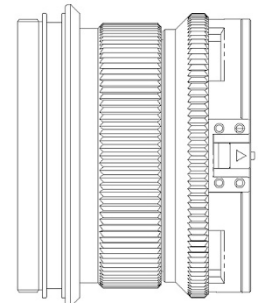

GX Standard Port LD

Compatible housing: (as of December 2018)

- INON *X-2 for GX9*

Compatible lens : (as of December 2018)

- *Panasonic LUMIX G VARIO 14-42mm/F3.5-5.6 II ASPH./MEGA O.I.S. (*1)*
- (*1) Auto focus (AF) only.

Compatible attachment lens : (as of December 2018)

- *GX Standard Port M67*
 - Close-up lens (*2): *UCL-330, UCL-165M67, UCL-90 M67, UCL-67 M67*
 - Wide conversion lens: *UWL-H100 28M67 Type2, Dome Lens Unit II for UWL-H100*
 - Other lens/filter: *UFL-M150 ZM80 (*3), UW Variable Red Filter M67*
- *GX Standard Port LD*
 - Close-up lens (*2): *UCL-165LD, UCL-90 LD, UCL-67 M67*
 - Wide conversion lens: *UWL-H100 28LD, Dome Lens Unit II for UWL-H100*
 - Other lens: *UFL-M150 ZM80 (*4)*

(*2) Usable underwater only with zoom range of middle to telephoto side. Using on land and zoom wide side setting underwater will have vignetting.

(*3) *Optional M27-M67 Mount Converter for UFL-M150 ZM80* is required.

(*4) *Optional M27-LD Mount Converter for UFL-M150 ZM80* is required.

Installation/usage :

- Attach the *GX Standard Port M67/LD on the compatible housing or EXT. Ring*. Make sure that there is no dust/damage on the Port O-ring, O-ring groove and O-ring contact surface of the housing/EXT. Ring. Slowly screw the port clockwise on the housing/EXT. Ring until it stops without any gap between the edge of the port mount of the housing/EXT. Ring and the *GX Standard Port M67/LD*. **DO NOT** screw too fast or too tight to prevent damage on the O-ring or anchoring of the *GX Standard Port M67/LD* to the housing.

- Installing/removing:
Lens Adapter** :
- The *Lens Adapter* has M65 screw mount and is screwed on the port edge. To dismount the *Lens Adapter*, hold the port firmly, then turn the adapter counter-clockwise.
 - To attach the *Lens Adapter* on the port edge, hold the port firmly and tighten the *Lens Adapter* clockwise completely until it stops.
- Pre-use check** :
- **Immerse assembled housing/port in a container (i.e. bathtub) with fresh water (below 30°C/86°F) to check if the port has been properly assembled to keep waterproof property. There must be no flooding inside of the assembled housing/port.**
Refer to housing user manual for detail of pre-use check.
- Maintenance** :
- After using underwater, first rinse and then soak the housing/port in fresh water (below 30°C/86°F) for several hours to dissolve any salt build-up. Refer to housing user manual for detail.
 - **Blow off remaining water** and leave the housing at shaded and well-ventilated area to dry **with no water drops/moisture on the port surface** (it may take several days to completely dry). Remaining water/moisture on the port surface may cause burn/spot.
 - When you remove the control ring, apply thin film of supplied grease on inner surface of the control ring. For maintenance method of O-ring of the housing, refer to housing user manual.
- Handling
Precautions** :
- Protect from impact shock and vibration, such as vibrating boat deck to prevent malfunction or flooding of the product.
 - **DO NOT** expose to extra heat, such as inside of a sun-heated car, or in hot direct sunlight, such as a beach or boat deck. Doing so may cause damage and subsequent flooding.
 - **DO NOT** hold the threaded part of this product with bare hands as sharp threads can cut your skin.
- Option** :
- *GX Lens Adapter M67*
Exclusively designed for *GX Standard Port/MRS GX Macro Port* to hold M67 screw type wet lens.
 - *GX Lens Adapter LD*
Exclusively designed for *GX Standard Port/MRS GX Macro Port* to hold LD bayonet type wet lens.
 - *O-ring for GX Port/EXT. Ring* [service part]
Replacement INON oil-bearing yellow O-ring for Port/GX Ext. Ring.
 - *INON Grease*
Grease for INON oil-bearing yellow O-ring.

INON Inc.

2-18-9, Dai, Kamakura,
Kanagawa 247-0061 JAPAN
E-mail support@inon.co.jp
Fax. +81(0)467-48-2178
URL http://www.inon.jp/

December 2018