

# INON ARM System

## Shoe Base Spacer

### Features

An optional product to attach Shoe Base on compatible Float Arm or Mega Float Arm.

Also accepts installation of the Shoe Base on combination of M5 Joint and Stick Arm Body or Multi Ball Arm Body.

### How to attach

#### ●When installing on compatible Stick Arm Body/Multi Ball Arm Body via M5 Joint

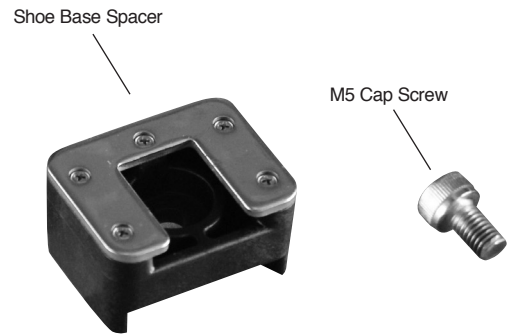
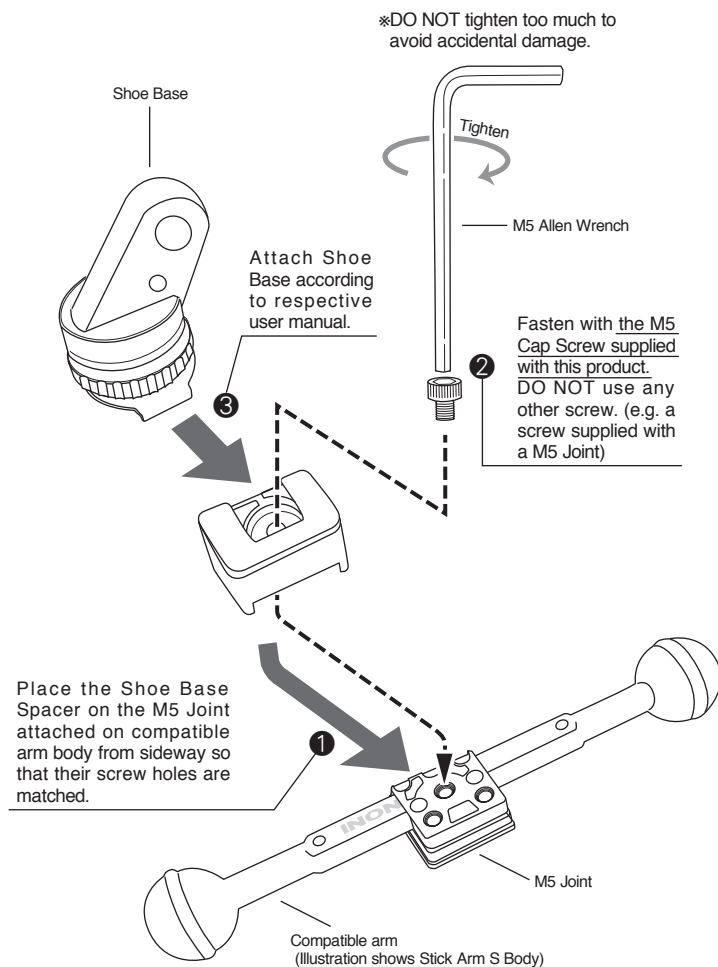

### Specifications

Package contents Shoe Base Spacer x 1, M5 Cap Screw x 1, M5 Allen Wrench x 1

Material Polycarbonate, stainless

Dimensions 32mm(W) x 17.7mm(H) x 25mm(D), 1.3" (W) x 0.7" (H) x 1.0" (D)

Weight 19.5g (air) / approx.12g (u/w) 0.7oz (air) / approx.0.4oz (u/w)

Compatible arm etc.

Float Arm S/M/ML, Mega Float Arm S/M, M5 Joint + Stick Arm XS/SS/S/M/L Body, M5 Joint + Multi Ball Arm S/ML/L/LL/XL Body

#### ●When installing on Float Arm/Mega Float Arm

