

INON

ARM II System

M6 Joint

Features

The M6 Joint is an optional product to attach Direct Base III on Stick Arm Body or Multi Ball Arm Body.

How to attach

● Attach M6 Joint on compatible arm.

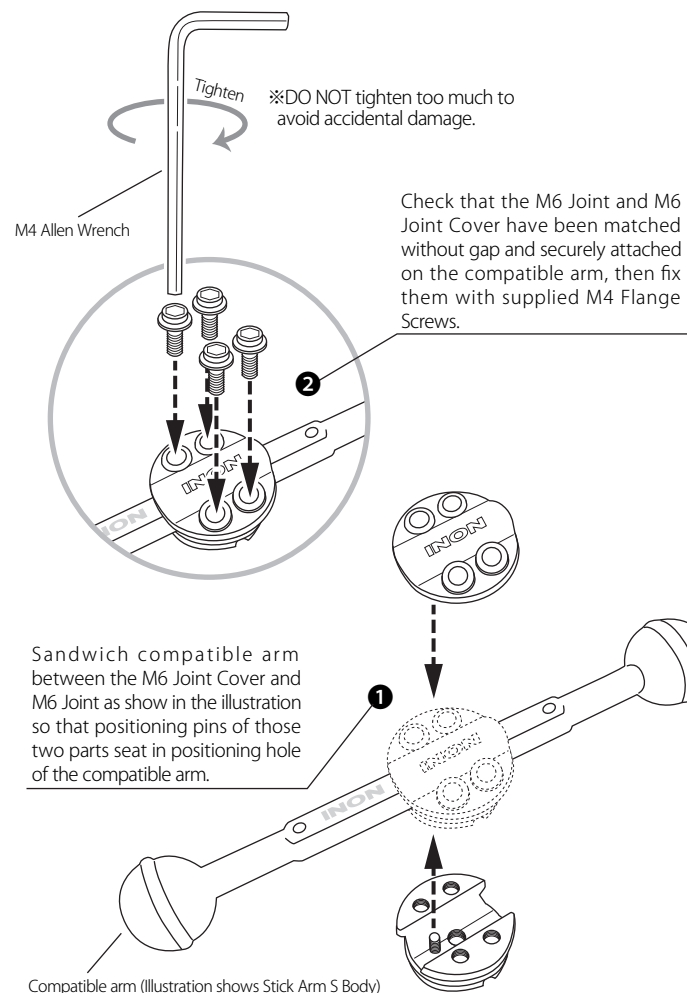

Note: The Direct Base III combined with an arm via this product, can hold single strobe or 2 x LED flashlights with a Clamp but not able to accept any heavier combination like a strobe and an LED flashlight together, three or more LED flashlights or attaching single strobe or 2 x LED flashlights via arm with 2 x Clamps.

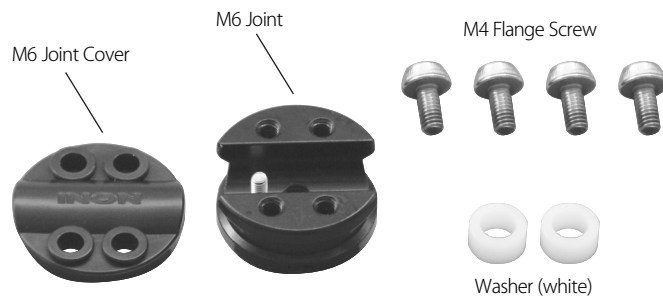

Specifications

- Package contents M6 Joint x 1, M6 Joint Cover x 1, M4 Flange Screw x 4, Spare O-ring x 1 (for Direct Base III), M4 Allen Wrench x 1, Washer (white) x 2 (incl. spare x 1)
- Material Corrosion resistant aluminum alloy, Polycarbonate, Polyoxymethylene, Stainless, Rubber
- Dimensions $\phi 30\text{mm}$ (Max.) x H: 22.1mm (with being attached on compatible arm), $\phi 1.2''$ (Max.) x H: 0.9'' (with being attached on compatible arm)
- Weight 24.3g (air) / approx.15g (u/w)
0.9oz (air) / approx.0.5oz (u/w)
- Compatible arm Stick Arm XS/SS/S/M/L Body, Multi Ball Arm S/ML/L/LL/XL Body,

● Prepare Direct Base III

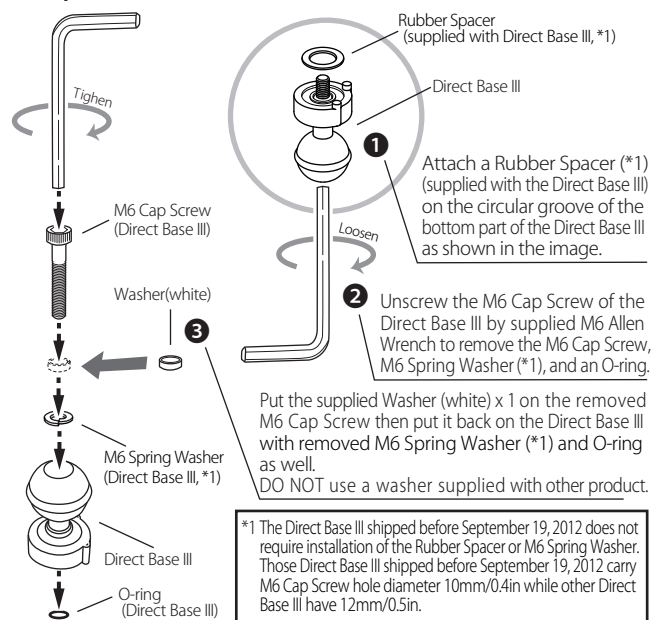

● Installing Direct Base III

Put the Direct Base III on the back surface of the M6 Joint so that notches of the M6 Joint accept protrusions of the Direct Base III as shown in the illustration below.

