

# INON

## Light Adapter for GoPro

### Package contents

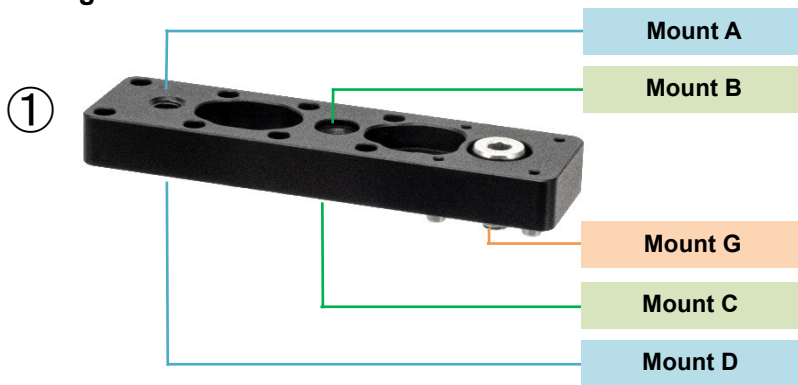

- |                                |    |
|--------------------------------|----|
| ① Light Adapter for GoPro      | ×1 |
| ② Lens Holder Base S for GoPro | ×1 |
| ③ M6 x 10 Cap Screw            | ×2 |

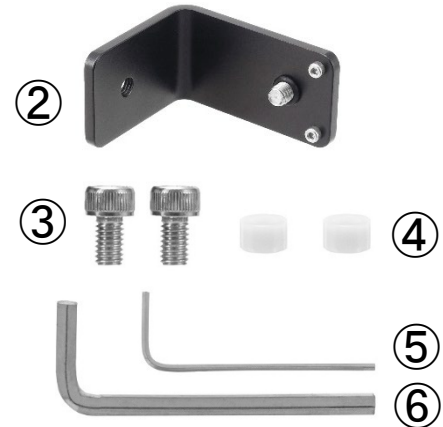

- |                         |    |
|-------------------------|----|
| ④ M6 Spacer (6 mm)      | ×2 |
| ⑤ Allen Wrench (1.5 mm) | ×1 |
| ⑥ Allen Wrench (4 mm)   | ×1 |

### Installation

#### Mount G

#### A GoPro housing can be installed via INON SD Front Mask

Align the preinstalled M6 low-head cap screw of the **Mount G** with the M6 screw hole of the Front Mask base and firmly tighten with a "Allen Wrench 4 mm"

\*GoPro housing cannot be attached on this product without the SD Front Mask.

\*When taking out the camera, first remove the housing from the SD Front Mask then take out the camera.

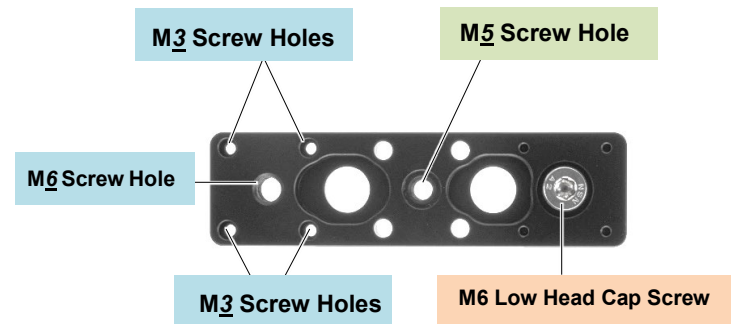

#### Mount A/D

#### Various INON adapters can be installed

Use an Allen Wrench packaged in each product.

#### ● Direct Base III

1. Remove the preinstalled M6 cap screw, insert the supplied "M6 spacer", then re-set it.
2. Align the M6 cap screw/projections with the **Mount A/D** and tighten with an Allen Wrench to secure firmly.

\* Do not remove the preinstalled M6 spring washer.

#### ● Z Joint

1. Replace the preinstalled M6 cap screw with packaged M6 x 10 cap screw, then re-set it\*.
2. Align the M6 x 10 cap screw/projections with the **Mount A/D** and tighten with an Allen Wrench to secure firmly.

\* Keep removed M6 cap screw for future use

#### ● Direct Base YS RT

- Align the M6 cap screw/projections with the **Mount A/D** and tighten with an Allen Wrench to secure firmly.

#### ● Male Adapter (GoPro) \*Packaged in SD Front Mask

- Align the M3 cap screws with the M3 threaded holes (4 locations) on the **Mount A/D** and tighten with an Allen Wrench to fasten securely.

\* Please note that only **one** Male Adapter (GoPro) can be attached from either side of the **Mount A/D**.

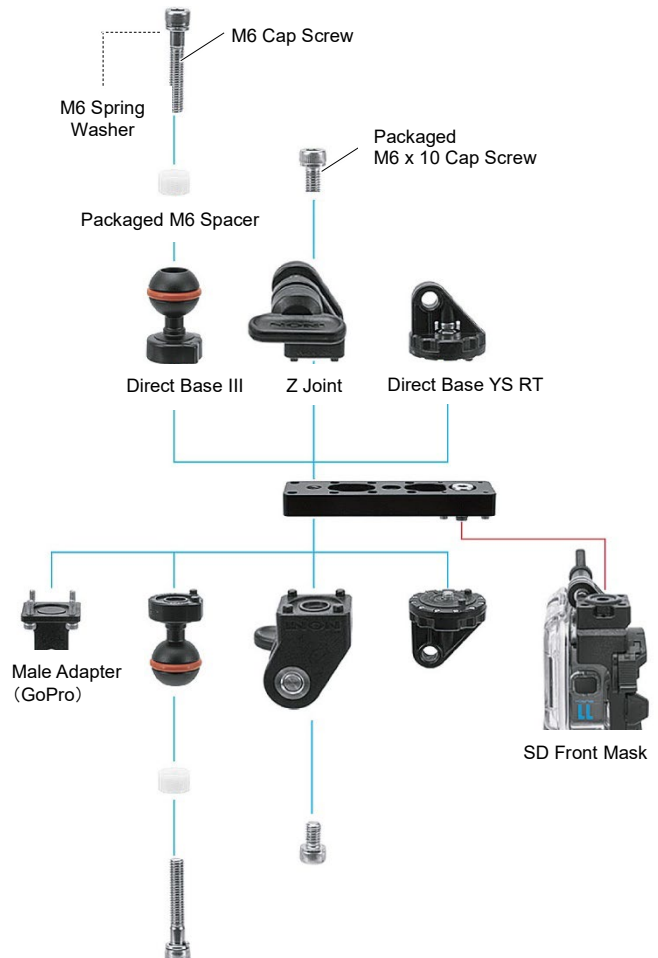

## Mount B/C

### Packaged “Lens Holder Base S for GoPro” / “AD Lens Holder for Float Arm” can be installed

#### ● Installing both “Lens Holder Base S for GoPro” and “AD Lens Holder for Float Arm”

Attach the Lens Holder Base S on the Mount B or C when other adapter has been installed on the Mount A.

1. Align the preinstalled M5 cap screw on the Lens Holder Base S with the M5 screw hole on the Mount B/C and tighten with packaged Allen Wrench 4mm to securely fasten.
2. Attach the AD Lens Holder for Float Arm to the M5 screw hole of the "Lens Holder Base S".

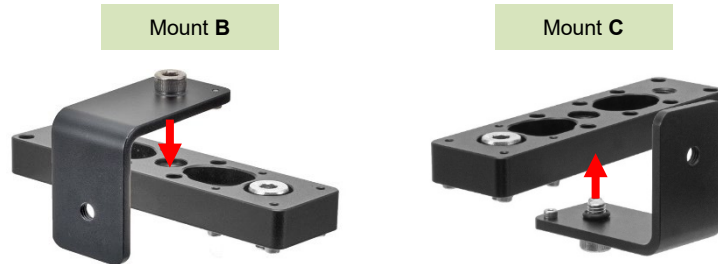
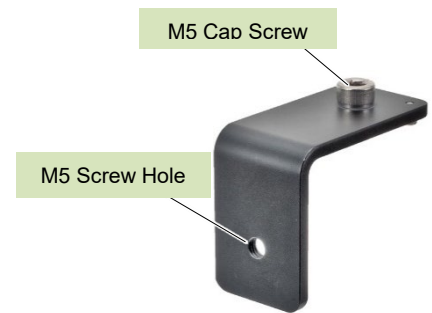

#### ● Directly attach “AD Lens Holder for Float Arm”

When nothing attached on the Mount A, AD Lens Holder for Float Arm can be attached on the Mount B.

- Attach the AD Lens Holder for Float Arm to the M5 screw hole on the Mount B/C.

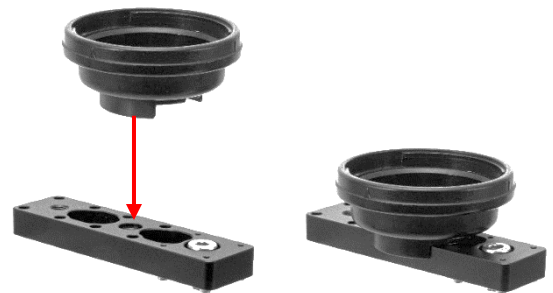

- Maintenance** :
- After using, soak in fresh water to dissolve remaining salt or remove dirt and dry it in shaded and well ventilated area. Never apply flame or direct heat to this product or damage may result
  - **DO NOT** clean with organic solvent like alcohol, benzene or thinner and oil and fat containing / chemical material like rust inhibitor, lubricant, polish, detergent (especially polyoxymethylene) to avoid damage/deformation/degradation of this product.
  - Periodically apply grease (grease for housing) on metal part of screws to prevent rust.
- Storage** :
- Store out of direct sunlight in well-ventilated, dry area. Avoid storing near chemicals, high ozone, large temperature and humidity fluctuations to avoid deformation, damage, rust, mold or corrosion etc.
  - Keep the product out of reach of children. They may swallow parts of this product. See a doctor immediately if a child swallow parts.
- Handling** :
- Be sure to install each compatible product securely. If the cap screws/thumb screws, etc. are not properly tightened, compatible products may fall off, damaged, or lost.
  - Hold this product during transportation of whole system without applying excessive shock, vibration and/or pressure. **DO NOT** hold compatible products to transport whole system to avoid accidental separation of combined housing/protector causing damage on them.

#### Light Adapter for GoPro Specifications [\*1]

Model	Light Adapter for GoPro
Size	W25.0 x H10.0 x D92.0 mm/
Weight [*2]	Air 68.2g/2.4 oz, underwater approx.44.7g/1.6 oz
Material/finishing	Corrosion-resistant aluminum alloy/rigid alumite/ POM etc.

\*1 Subject to change without prior notice

\*2 Including Lens Holder Base S for GoPro (air 17.9g/0.6 oz, underwater approx. 12.1g/0.4 oz)

INON Inc.

2-18-9, Dai, Kamakura,  
Kanagawa 247-0061 JAPAN  
E-mail support@inon.co.jp  
Fax. +81(0)467-48-2178  
URL http://www.inon.jp/

June 2023