

INON

INON SD Front Mask for GO 3S

Thank you for purchasing INON product.

The INON "SD Front Mask for GO 3S" is a multi-purpose product to attach INON SD Mount lens, arm etc. on Insta360 Dive Case

Package, Name of Parts

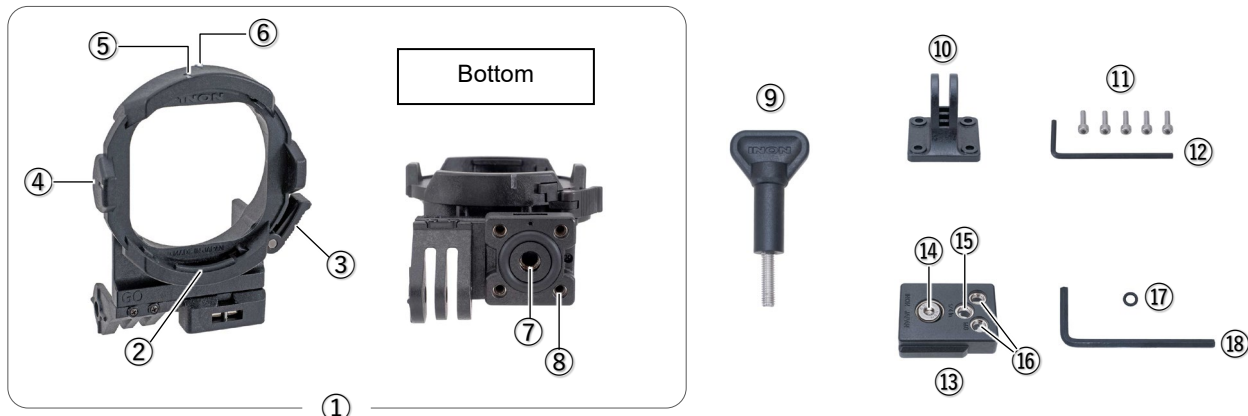

- ① SD Front Mask for GO 3S
- ② Lens Mount (SD bayonet mount)
- ③ Lock Lever
- ④ Guide A (Lens)
- ⑤ Guide B (Lens)
- ⑥ Guide C (Hood)
- ⑦ Optional Accessory Fixing Hole (M6 screw hole)
- ⑧ Male Adapter Fixing Hole (M3 screw hole x4)
- ⑨ M5 Thumbscrew

- ⑩ Male Adapter
- ⑪ Male Adapter Fixing Screw ×5 including one spare.
- ⑫ Allen Wrench (WAF:2.5mm)
- ⑬ Mount Adapter
- ⑭ M6×12 Low Head Cap Screw*
*pre-installed on the Mount Adapter
- ⑮ Tripod Screw Hole (1/4in. screw hole)
- ⑯ D5 Holder Fixing Hole (M6 screw hole ×2)
- ⑰ Spare O-ring (to hold M6x12 Low Head Cap Screw)
- ⑱ Allen Wrench (WAF:4mm)

Compatible Product

Compatible camera/housing

- Insta360 Dive Case for GO 3S

Compatible SD Mount Lens

- INON UFL-G140 SD underwater semi fisheye lens
- INON UCL-G165II SD underwater wide close-up lens

Compatible products attached on the [bottom] of this product

- INON Direct Base III, Z Joint, Z Adapter MV, Quick Holder Set S-Z, Shoe Base M6, Light Adapter for GoPro®

Compatible products attached on the [bottom] via packaged [Mount Adapter]

- INON D5 Holder, Shoe Base 1/4-20UNC, UW Tripod Hub, UW 3-Way Panhead
- Commercially available monopod, tripod

Compatible products attached on the [bottom] via packaged [Male Adapter]

- INON Ball Adapter for GoPro, Compact Grip Base for GoPro
- GoPro/Insta360 compatible mount

Installation

- Set the camera in the Dive Case
- Set the **SD Front Mask for GO 3S** on the Dive Case with INON logo facing front. Make sure there is no gap between the lens frame of the housing and the opening edge of this product.
- Fasten this product and the Dive Case with the bundled M5 Thumbscrew.



Lens Installation [UFL-G140SD, UCL-G165II SD]

- Match Guide A [Lens] with Guide A [Mask] as in below left image and put the male bayonet mount of the lens in the SD bayonet mount of this product.
- Rotate the lens clockwise until Guide A [Lens] is coupled with Guide B [Mask] where you should feel and hear clicking
- When removing the lens, with pressing the Lock Lever, rotate the lens counterclockwise.

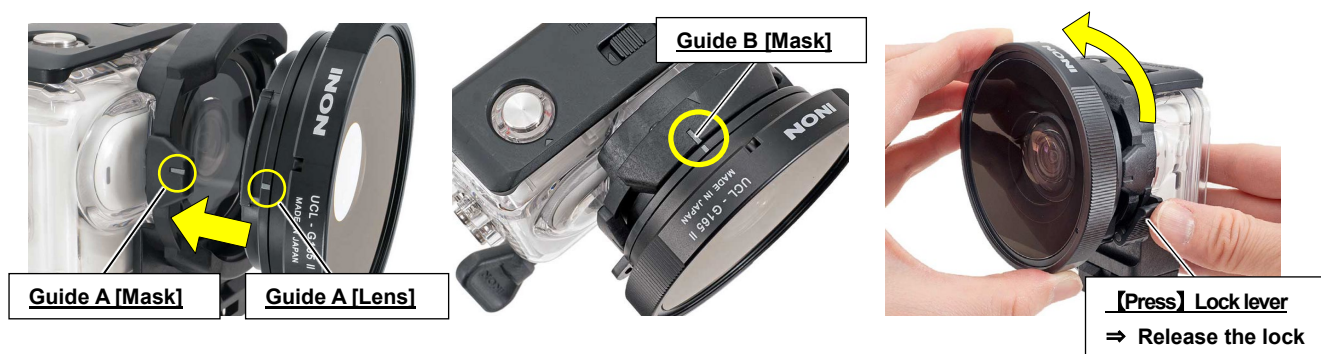

- Once submerged, remove the lens underwater and shake it well to drop trapped bubbles especially from the rear lens surface then install the lens on the SD Front Mask again following same procedure.

Installing Lens Hood [UFL-G140SD]

- Install the Lens Hood on the lens with the lens being attached to the SD Front Mask.
- Put the Lens Hood over the lens body all the way so that the “screw hole” under the INON logo on the hood and the “Guide C (▲)” on the top of the SD Front Mask are aligned.
- With holding the lens hood, lightly and evenly tighten the four hollow screws little by little drawing cross pattern.

! **DO NOT** overtighten as overtightening can damage the lens hood.



Male Adapter Installation

Place the adapter on the bottom of this product and fix with supplied 4 x Male Adapter Fixing Screws by using supplied Allen Wrench (WAF: 2.5mm). Using **Male Adapter** allows to attach optional accessories as per “selfie set” shown in the right.

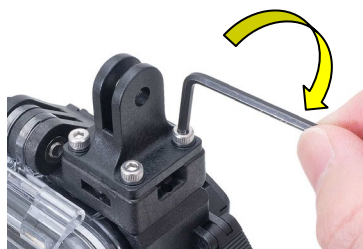
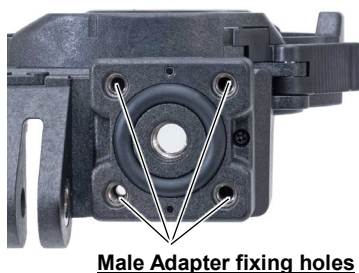

Direct Base III, Quick Hoder Set S-Z, Z Adapter MV Installation

Directly attachable at “M6 Screw Hole” on the bottom of this product.



Monopod, Tripod Installation via Packaged Mount Adapter

Attach the packaged **Mount Adapter** on the bottom of this product as in below images. Fasten it by pre-installed M6 Screw on the **Mount Adapter** firmly screwed into M6 Screw Hole by using supplied Allen Wrench (WAF: 4mm). A tripod etc. can be attached at Tripod Screw Hole (1/4in. screw hole) on the **Mount Adapter**.

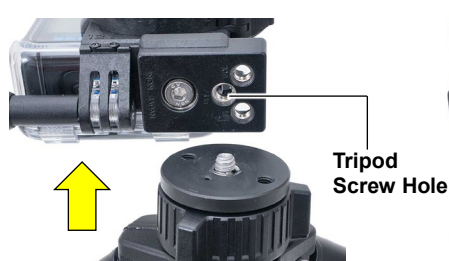
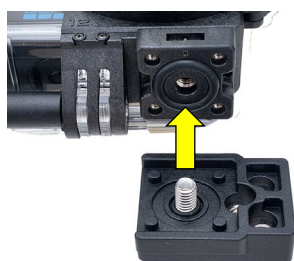

D5 Holder via packaged Mount Adapter

Attach the packaged **Mount Adapter** on the bottom of this product as in below images. Fasten it by pre-installed M6 Screw on the **Mount Adapter** by firmly screwed it into M6 Screw Hole by using supplied Allen Wrench (WAF:4mm). Optional **D5 Holder** is attached on the left side of this product at “M6 screw holes” on the **Mount Adapter**.

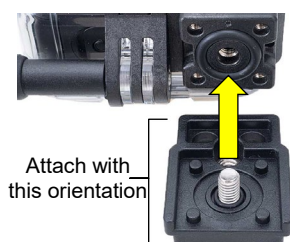

Before Installation

- **DO NOT screw the “M5 Thumbscrew” to the Front Mask body strongly without the Dive Case to prevent accidental damage.**
- DO NOT inquire of Arashi Vision Inc./Insta360 installation of this product as it is not under the control of Arashi Vision Inc./Insta360. The user must take full responsibility for the installation/use of this product.
- INON Inc. shall not be liable for any failure of the housing, housing accessory or camera due to installation/use of this product.
- INON Inc. shall not be liable in any way for any incidental damages (such as expenses incurred in taking pictures/footages or loss of profit that should have been gained by the pictures/footages) that may result from flooding or other problems caused by the installation/use of this product
- **Installation and use of this product shall be deemed as full consent of the user to the above conditions.**

Maintenance

- Apply thin film of grease to the top edge of screw shaft of adapters, base to prevent anchoring due to salt build-up.
- After use, rinse with fresh water to remove salt and other stains, and place in a well-ventilated area out of direct sunlight to dry thoroughly. DO NOT expose directly to fire or heat as this may cause deformation or damage.
- DO NOT use organic solvents such as alcohol, benzene, thinner, or oils/chemicals such as rust inhibitors, lubricants, glazing agents, or detergents (especially alkaline detergents) when cleaning the product. Some of the components of this product may change when exposed to the above substances, such as melting or becoming brittle.
- If the product is not used for more than a week, please remove and store it. Storing the product being attached on the combined product for extended period may cause deformation/damage due to continuous force applied to the combined product.

Specifications

INON SD Front Mask for GO 3S Specifications (*1)

Model	SD Front Mask for GO 3S
Size (*excl. handle)	68mm/2.7in (W) × 91.8mm/3.6in (H)×42.8mm/1.7in (D)
Weight	Air: approx.60g/2.1oz, underwater approx. 23g /0.8oz
Material/surface finishing	PC, POM etc.

(*1) Subject to change without prior notice

(*2) “Insta360” is trademark or registered trademark of Arashi Vison Inc.

INON Inc.

2-18-9, Dai, Kamakura,
Kanagawa 247-0061 JAPAN
E-mail support@inon.co.jp
Fax. +81(0)467-48-2178
URL <http://www.inon.jp/>

February 2025