

INON

INON AD Lens Holder / AD Lens Holder for Float Arm

Thank you for purchasing INON product.

INON AD Lens Holder is attached on compatible strobe arm / Grip Base to carry AD / 28AD / SD mount series attachment lens or dedicated optional product to help easy and speedy lens replacement underwater.

Features

- AD / 28AD / SD mount compatible to carry compatible lens on INON Arm body /YS Arm body/Float Arm body/Grip Base with one-touch installation.

- Package contents:**
- AD Lens Holder [screw] ① ×1 (**AD Lens Holder only**)
 - AD Lens Holder [hole] ② ×1
 - AD Lens Holder Base ③ ×1 (**AD Lens Holder only**)
 - Thumb Knob Screw ④ ×1 (**AD Lens Holder only**)
 - Cap Screw ⑤ ×1 (**AD Lens Holder only**)
 - Allen Wrench ⑥ ×1
 - This user manual ×1

- Compatible lens product** :
(as of October 2014)
- AD mount series
 - INON 「UCL-165AD」 Close-up Lens
 - INON 「UWL-105AD」 Wide Conversion Lens
 - INON 「UFL-165AD」 Fish-eye Conversion Lens
 - 28AD mount series
 - INON 「UWL-100 28AD」 Wide Conversion Lens
 - INON 「AD Mount Converter for UCL-165AD」
 - SD mount series
 - INON 「UFL-G140 SD」 Semi-fisheye Conversion Lens
 - INON 「UCL-G165 SD」 Wide Close-up Lens

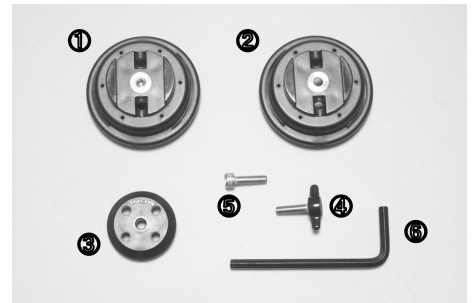

Compatible arm : Compatible AD Lens Holder type varies depending on combined strobe arm/Grip Base etc. Please make sure that your AD Lens Holder (or AD Lens Holder for Float Arm) is compatible with combined strobe arm/Grip Base etc. Compatible products are categorized as below based on 1) expandable AD Mount per unit and 2) maximum mountable number of this unit per compatible arm body / Grip Base / Float Arm. Maximum number of compatible AD/28AD attachment lens and dedicated optional parts per single strobe arm/Grip Base etc. can be calculated by "1) x 2)".

● Compatible with AD Lens Holder only 【AD Lens Holder for Float Arm is not compatible】

- Group ①
 - 1) One AD Mount per single AD Lens Holder
 - 2) Maximum one AD Lens Holder per Grip Base→ 【Maximum mountable lens is one】
 - NON Grip Base DII with Rubber Grip D, INON Grip Base DIII with Rubber Grip D
 - INON D Holder Extension Bar + Grip Base D4
 - INON D Holder Extension Bar + D Holder
- Group ②
 - 1) Maximum two AD Mounts per single AD Lens Holder
 - 2) Maximum one AD Lens Holder per arm→ 【Maximum two lenses can be carried】
 - INON Arm SS body, INON Arm S body, INON YS Arm MS body
- Group ③
 - 1) Maximum two AD Mounts per single AD Lens Holder
 - 2) Maximum two AD Lens Holders per arm→ 【Maximum four lenses can be carried】
 - INON Arm M body, INON YS Arm M body
- Group ④
 - 1) Maximum two AD Mounts per single unit
 - 2) Maximum three AD Lens Holders per arm→ 【Maximum six lenses can be carried】
 - INON Arm L body

● Compatible with AD Lens Holder and AD Lens Holder for Float Arm

- Group ⑤
 - 1) One AD Mount per single AD Lens Holder/AD Lens Holder for Float Arm
 - 2) Maximum two AD Lens Holder/AD Lens Holder for Float Arm per Float Arm→ 【Maximum two lenses can be carried】
 - INON Float Arm S body, INON Float Arm M body, INON Float Arm ML body
 - INON Mega Float Arm S body, INON Mega Float Arm M body

How to use : • **Attach one AD Mount on compatible product in Group ①~④ 【AD Lens Holder only】**

Attach the AD Lens Holder [screw] and the AD Lens Holder Base on compatible arm as shown in images below so that the arm seats in groove between the lens holder and the base. *INON logo on the AD Lens Holder Base must face you. Then fix them by the Thumb Knob Screw.

Refer to 「D Holder Extension Bar」 user manual for detail of using with the 「D Holder Extension Bar」



• **Attach two AD Mounts on compatible product in Group ②~④ 【AD Lens Holder only】**

Attach the AD Lens Holder [screw] and the AD Lens Holder [hole] on compatible arm as shown in images below so that the arm seats in groove between the two parts. *AD Lens Holder (hole) must face you. Then fix them with the Cap Screw by using supplied Allen Wrench. DO NOT tighten too much to avoid damage on the AD Lens Holder.



• **Attach one AD Mount on compatible product in Group ⑤ 【AD Lens Holder/AD Lens Holder for Float Arm】**

Attach the AD Lens Holder [hole] on compatible product as shown in image [left] below so that the Lens Holder base on the compatible product seats in groove of the AD Lens Holder [hole]. Then fix it by the Cap Screw supplied with compatible product.

DO NOT use supplied cap screw comes with this product or compatible product in Group ⑤ will be damaged. Use supplied cap screw with Float Arm

DO NOT tighten too much to avoid accidental damage on the AD Lens Holder.



• **Attach two AD Mounts on compatible product in Group ⑤ 【AD Lens Holder/AD Lens Holder for Float Arm】**

Prepare additional AD Lens Holder[hole] included in AD Lens Holder or additional AD Lens Holder for Float Arm and attach to the Lens Holder base on the other side of compatible product in group ⑤ by following same procedure described in previous section. 【It is necessary to prepare two AD Lens Holders or two AD Lens Holder for Float Arm】

• **How to attach AD / 28AD / SD mount series lens**

Follow same procedure to attach on AD Mount Base / 28AD Mount Base / SD Mount Cage / 28AD Port.

INON Inc. 2-18-9, Dai, Kamakura, Kanagawa 247-0061
 E-mail support@inon.co.jp / Fax. +81(0)467-48-2178
 URL <http://www.inon.co.jp/>
 October 2014