

INON

INON Optical D Slave Cable 3 Type L

Thank you for purchasing INON product.

INON Optical D Slave Cable 3 Type L is a fiber optics to connect a master strobe and a slave strobe supporting reliable "Optical D Slave Cable" connection without influence of ambient light.

The Optical D Slave Cable 3 Type L can have extra "Optical D Cable LL" enabling 『Optical D Slave Cable connection』 from master strobe to other 2 slave strobes.

Only certain combination can have full benefit of this product. Refer to [Compatible master strobe] / [Compatible slave strobe] below for detail.

- Package contents** :
- Optical D Cable LL Type L ① ×1
 - Slave D Holder Unit 3 ② ×1
 - Optical Guide Cap WL ×1
 - Cap Fixing Dial ×1
 - Fiber Optics Fixing Dial ×1
 - Fiber Optics Fixing Rubber ×1
 - Spare Fiber Optics Fixing Rubber ③ ×1
 - This user manual ×1

- Compatible master strobe** (as of November 2018) :
- INON S-2000

- Compatible slave strobe** (※1) (as of November 2018) :
- **Wireless compatible strobes (Optical D Cable Type L is attached as it is)**
INON Z-330, D-200, S-2000, Z-240 [Type 4], D-2000 [Type 4]

Wireless non-compatible strobes (Sensor Plug has to be replaced with optional "Sensor Plug - Non-Wireless" (※))

- INON Z-240 [Type 3/ Type 2/ Type 1], D-2000 [Type 3/ Type 2/ Type 1], D-2000W, D-2000Wn, D-2000S, D-180, D-180S, Z-220F, Z-220S, Z-220
- INON TTL Sensor Z + INON Z-22
- INON TTL Sensor SB + compatible TTL auto strobe
- INON TTL Sensor YS + compatible TTL auto strobe
- INON Focus Light Controller + INON Z-220F/Z-220S/Z-220/Z-22



*[Sensor Plug - Non-Wireless]
[Optional]*

(※) Refer to an instruction manual 『L-Connector Modification Instruction』 which comes with the optional 『Sensor Plug - Non-Wireless』 for detail of replacement

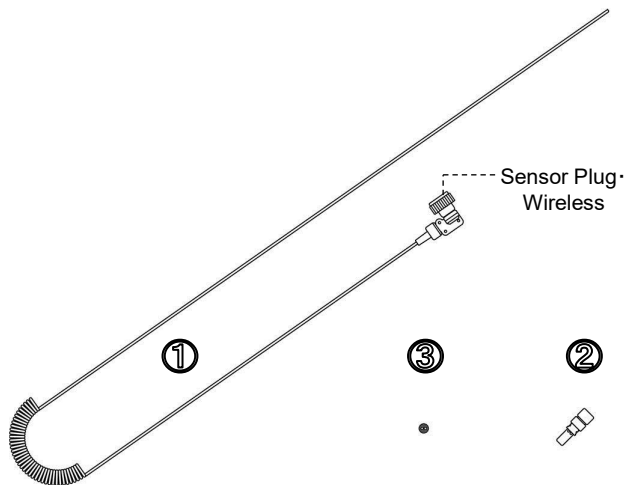

When different strobes are used as a master and a slave, unintentional imbalance may be observed except both strobes are set to Manual mode. [e.g. Imbalance flash output though intending to create 『flat lighting』 with equal flash output from master/slave strobe etc.]

This is normal because each strobe model has unique specification like [maximum flash power/flash time/flash intensity per unit time] or imbalance caused by operational characteristic of slave flashing in each auto flash mode.

To adjust flash output balance, 『flash output adjustment on each strobe』, 『using appropriate "diffuser"』 or 『attaching both strobe directly to camera system (without using this product)』 may be necessary. Refer to strobe's user manual for recommended connection/setting for dual strobe configuration.

- Connection method** :
- **Install Slave D Holder Unit 3**
Unscrew the metal "Cap Fixing Dial" of the "Slave D Holder Unit 3", then attach it on compatible master strobe "Optical D Slave Cable III Adapter" so that the 『flat surface』 of the "Optical Guide Cap WL" (white plastic part) is face-up. Tighten the "Cap Fixing Dial" to fasten the unit with holding the "Optical Guide Cap WL" by finger so that the "Optical Guide Cap WL" is not turned around.

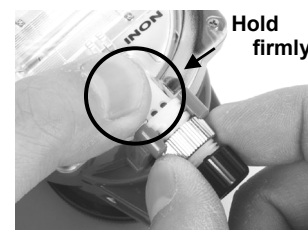
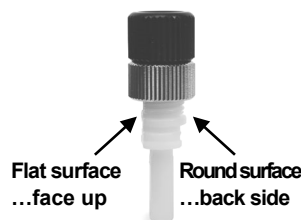

• **Attach Optical D Cable LL Type L**

Unscrew black “Fiber Optics Fixing Dial” of the “Slave D Holder Unit 3”, and then insert the bear end of the “Optical D Cable LL Type L” all the way. Tighten the “Fiber Optics Fixing Dial” to securely fasten the cable with holding the “Optical Guide Cap WL” by finger so that the “Optical Guide Cap WL” is not turned around. If you use a diffuser, hold the “Optical Guide Cap WL” through the diffuser so that the “Optical Guide Cap WL” is not turned around.
The “Slave D Holder Unit 3” can have extra “Optical D Cable LL” together with supplied “Optical D Cable LL Type L”. Attach the cable to master strobe slave sensor.

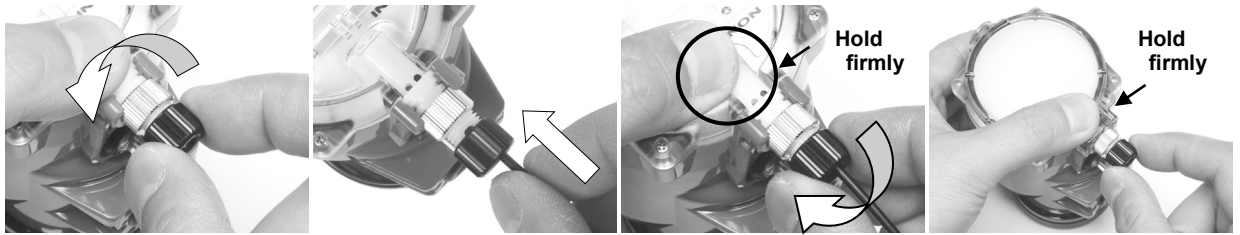

Maintenance

- **First remove “Optical D Cable LL Type L” and “Slave D Holder Unit 3” from strobe/diffuser after use** and soak them in fresh water (below 30°C/86°F) for several hours to dissolve any salt build up. Blow off water drop by air gun/blower and dry them in shaded and well ventilated area. It may take several days to completely dry.
- Especially **take care to clean the both edge of the “Optical D Cable LL Type L” with the cable removed from the “Slave D Holder Unit 3” to dissolve any salt build up. Scratch or cloud with salt build up on the edge may lead poor signal transmission.**
- Be careful not to lose parts of removed “Slave D Holder Unit 3”.
- In the event of poor signal transmission resulting from scratch/cloud or necessity to shorten the cable, it is possible to cut the cable to refresh the damaged edge or to get desired length. Refer to our web site below to cut strobe connector side.

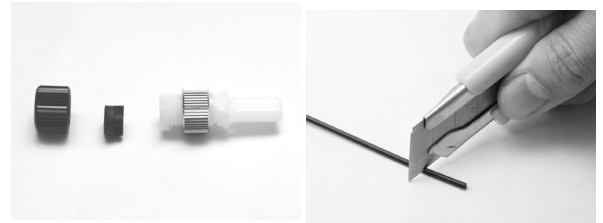

“L Connector Modification Instruction”

http://www.inon.jp/pdf-dl/_userdata/ModifyCableConnector-en.pdf

When you cut the Optical D Cable Type L, use sharp blade like a razor or a utility knife and make sure to cut the edge flatly. If you observe roughness on the cable section, cut it again to prevent poor signal transmission.

Handling precaution:

- “Optical D Cable LL Type L” has ultra durability (minimum bend radius 2mm) but **inner portion could be damaged when bending less than radius of 2mm or excessive shock.** And **if the cable being bended for long time, it will not back to original shape.** Replace with optional [Replacement Optical D Cable LL Type L/Optical Slave Cable Type L] in case of poor signal transmission.
- When carrying your camera system, DO NOT hold the Optical D Cable LL Type L with being connected to a housing or a strobe to prevent the fiber optics coming off from the L- Connector or accidental damage on strobe/L-Connector/Optical Cable etc.

Optional parts

- **Optical D Cable LL Type L**
① in the product illustration. Necessary to directly connect two compatible slave strobes with the Slave D Holder Unit 3.
- **Replacement Optical D Cable LL Type L**
① in the product illustration without connector.
- **Slave D Holder Unit 3 with spare parts**
② and ③ in the product illustration.
- **L-Connector Kit (strobe)**
Replacement strobe connector unit without a cable. Same strobe connector as originally installed on this product.
- **Sensor Plug · Wireless**
Replacement sensor plug unit originally installed on this product.
- **Sensor Plug · Non-Wireless**
Replacement Sensor Plug unit to be replaced with originally installed Sensor Plug to use for Non-Wireless strobes described on the first page of this manual..

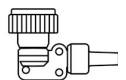

INON Inc.
2-18-9, Dai, Kamakura,
Kanagawa 247-0061 JAPAN
E-mail support@inon.co.jp
Fax. +81(0)467-48-2178
URL <http://www.inon.co.jp/>

November 2018